

**RESOLUTION NO. 2025-01**

**A RESOLUTION OF THE CITY COUNCIL OF THE CITY OF NEW PORT RICHEY, FLORIDA ADOPTING AND APPROVING A CITY DOCK MAP ATTACHED HERETO PURSUANT TO SECTION 5-44 OF THE CODE OF ORDINANCES, AS PROVIDED HEREIN.**

WHEREAS, section 5-44 of the Code of Ordinances authorizes the adoption of a City Dock Map establishing locations where designated private property owners may construct a dock attached to City-owned property adjacent to the Pithlachascotee River;

WHEREAS, the City Council desires to approve the attached City Dock Map; and

WHEREAS, the City Council hereby finds that this Resolution is in the best interests of the health, safety and welfare of the citizens of the City.

NOW, THEREFORE, BE IT RESOLVED by the City Council of New Port Richey, Florida, that the City Dock Map attached hereto and incorporated herein is hereby adopted and approved, and the City Manager is hereby authorized to take all actions consistent therewith.

DONE AND RESOLVED on the 15<sup>th</sup> day of October, 2024.

ATTEST:

\_\_\_\_\_  
Judy Meyers, MMC, City Clerk



\_\_\_\_\_  
Alfred C. Davis, Mayor

Approved as to form:

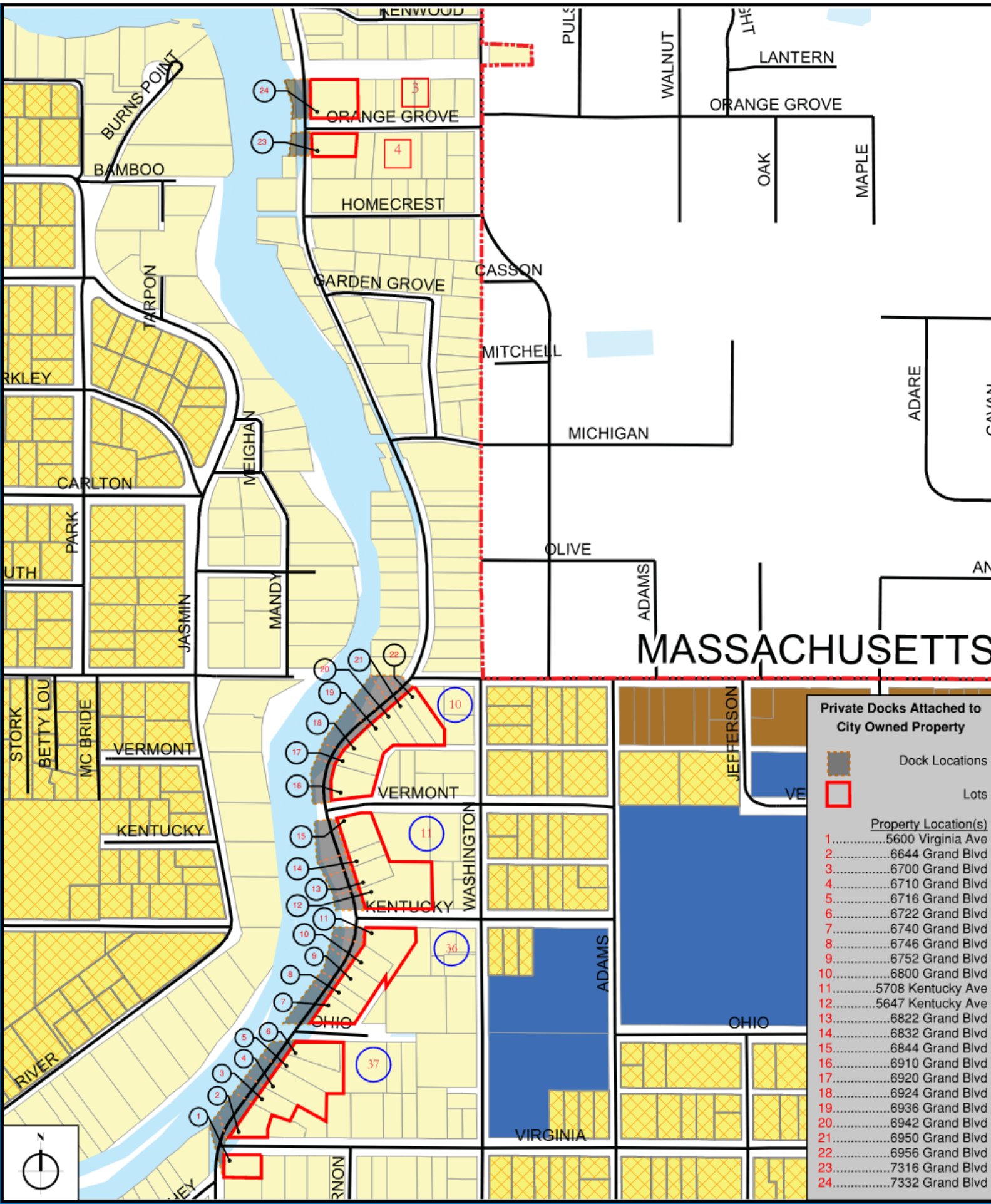
\_\_\_\_\_  
Timothy P. Driscoll, City Attorney



**Private Docks Attached to City Owned Property**

-  Dock Locations
-  Lots

Property Location(s)

1.....	5600 Virginia Ave
2.....	6644 Grand Blvd
3.....	6700 Grand Blvd
4.....	6710 Grand Blvd
5.....	6716 Grand Blvd
6.....	6722 Grand Blvd
7.....	6740 Grand Blvd
8.....	6746 Grand Blvd
9.....	6752 Grand Blvd
10.....	6800 Grand Blvd
11.....	5708 Kentucky Ave
12.....	5647 Kentucky Ave
13.....	6822 Grand Blvd
14.....	6832 Grand Blvd
15.....	6844 Grand Blvd
16.....	6910 Grand Blvd
17.....	6920 Grand Blvd
18.....	6924 Grand Blvd
19.....	6936 Grand Blvd
20.....	6942 Grand Blvd
21.....	6950 Grand Blvd
22.....	6956 Grand Blvd
23.....	7316 Grand Blvd
24.....	7332 Grand Blvd