

With its heavy-duty cast-iron construction and fast priming capabilities, this solids handling, trailer mounted, sound attenuated pump leads the industry in construction, industrial and municipal applications. The Thompson 4JSVM-DIST-4LE2T-MC is designed for moderate flows and heads to 132 feet making it perfect for sewage bypass pumping or general construction dewatering. The 4JSVM-DIST-4LE2T-MC pump provides flow rates up to 1,200 gpm and solids handling to 3".

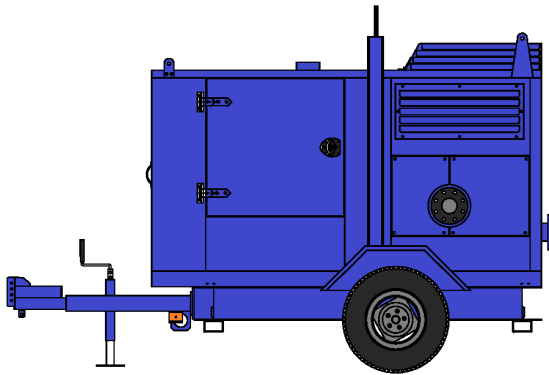

Consult factory for other versions & options including site trailers, sound attenuation, etc.

### ENVIROPRIME SYSTEM<sup>®</sup> with OVT

- Thompson's innovative priming system preventing blow-by of sewage, effluent and waste from discharging onto the ground. This system, with Thompson's OVT system, offers 97 SCFM air handling capabilities for quick priming.

<b>Materials</b>	
<b>Pump Casing</b>	Heavy-duty class 30 cast-iron
<b>Impeller</b>	Dynamically balanced, non-clogging, enclosed, 65-45-12 ductile iron with rear-equalizing vanes to reduce axial loading and prolong seal and bearing life; diameter 8.25"
<b>Mechanical Seal</b>	Dry-running, grease or oil lubricated with Tungsten Carbide rotating and Silicon Carbide stationary seal faces. Single inside mounted, non-pusher type with self-adjusting elastomeric bellows. Other components are 304 stainless steel and viton
<b>Head</b>	Rugged, back pull out design, heavy-duty class 30 cast iron with tapered bore design
<b>Bearings</b>	Heavy-duty grease lubricated to carry both axial and radial loads
<b>Shaft</b>	High quality 'stress-proof' steel

### TECHNICAL SPECIFICATIONS

Suction Size	4 in (10.16 cm)	Approximate Dry Weight	5,240 lbs
Discharge Size	4 in (10.16 cm)	Fuel Tank	100 gal (378.54 L)
Maximum Flow Capacity	1200 gpm (272.4 m <sup>3</sup> /h)	Fuel Consumption @2200rpm	1.71 gph (6.47 L/h)
Maximum Head	132 ft (40.23 m)	Best Efficiency Point	79 %
Maximum Solids Handling	3 in (7.62 cm)	Maximum Operating Times	Fuel Economy
Maximum Operating Speed	2200 rpm	58 hours @ 2200 rpm	0.399 lb/hp-hr @ 2200 rpm
Maximum Operating Temp.	200 °F (93.33 °C)	73 hours @ 2000 rpm	0.396 lb/hp-hr @ 2000 rpm
Maximum Operating Pressure	57 psi (393 kPa)	90 hours @ 1800 rpm	0.386 lb/hp-hr @ 1800 rpm

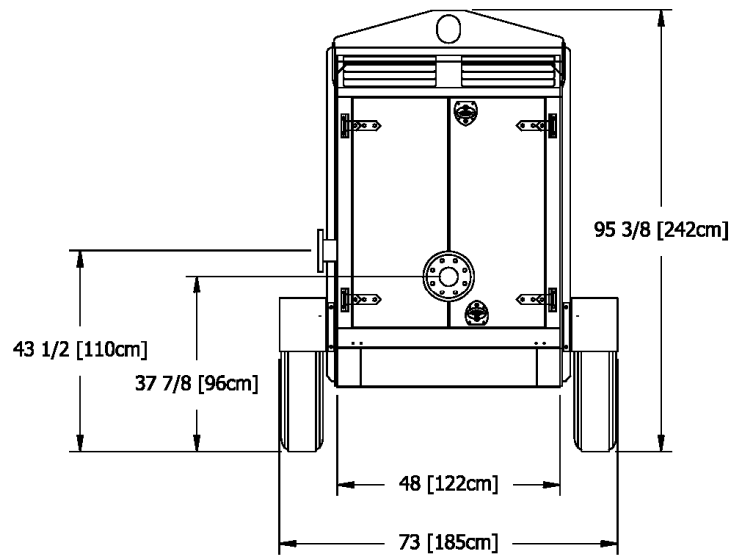
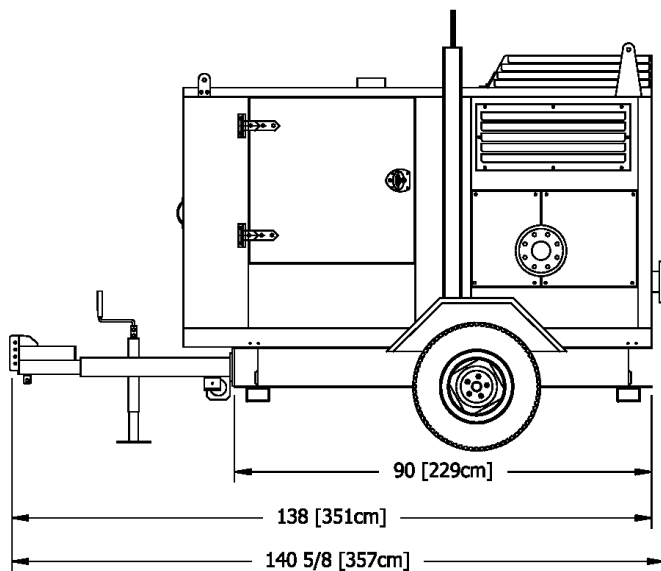
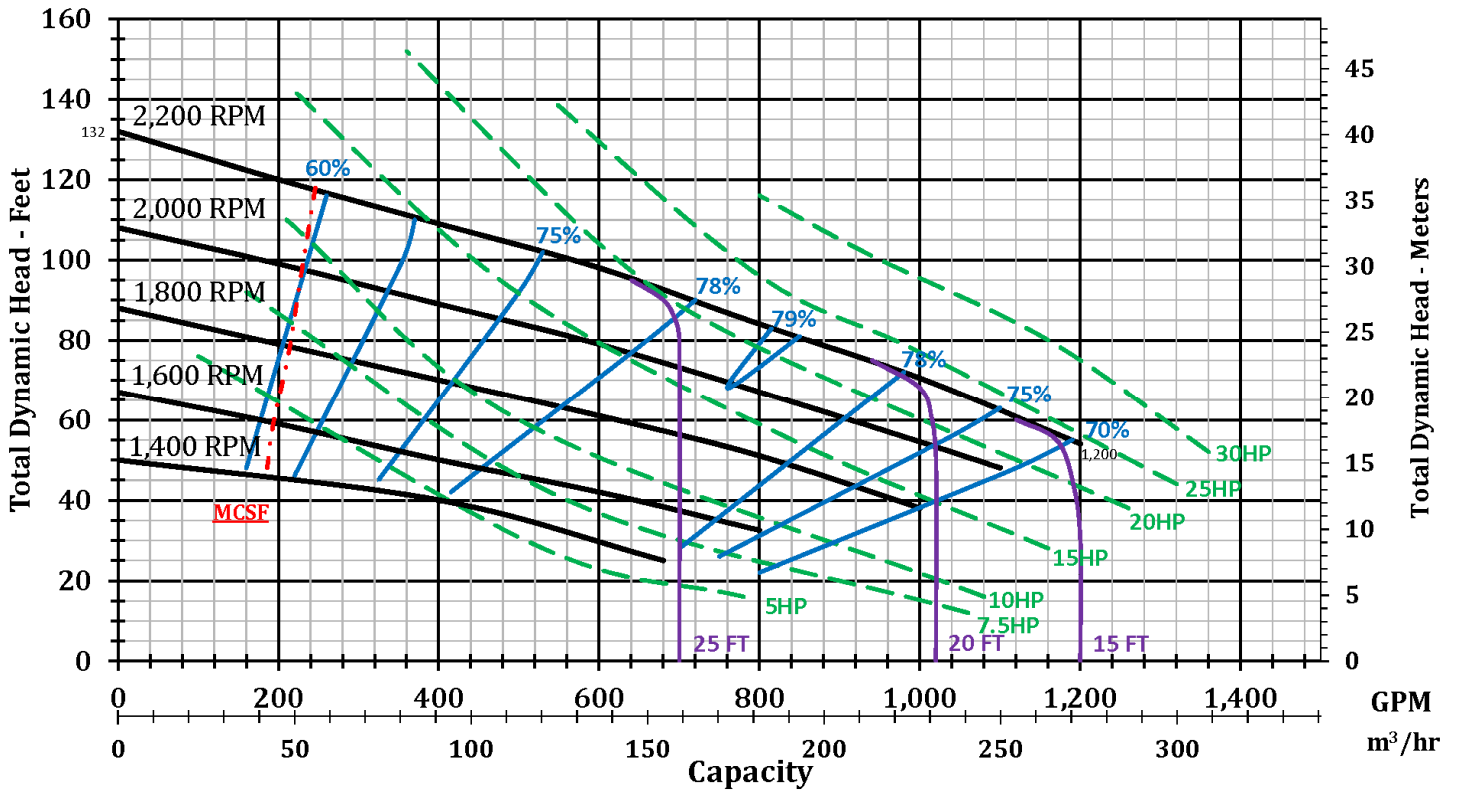

### Engine Specification

<b>Engine Model</b>	Isuzu 4LE2T 40 HP @ 1800 rpm	<b>Standard Equipment</b>	Cooled EGR, Wastegate Turbo-charger, emission control device, alternator, radiator
<b>Type</b>	EPA Final Tier 4, In-Line, 4-Cycle, Turbocharged, high-pressure common-rail diesel	<b>Automatic Shutdowns</b>	Low lube oil pressure; high water temperature

Specifications and illustrations are subject to revision without notice and without incurring any obligation for previous or subsequent equipment sold. Thompson Pump (ISO 9001:2008) makes no representation regarding the completeness or accuracy of this information and is not liable for any direct or indirect damages arising from or relating to this information or its use. Capacity & Head are shown for comparative purposes. Consult Thompson factory for exact capabilities.